



Parent Briefing: Friday 3rd May

MONDAY 6th MAY – BANK HOLIDAY

A reminder that Monday is a Bank Holiday and, therefore, school is closed. It reopens on Tuesday 7th May at the usual time.

YEAR 7 RESIDENTIAL

The inaugural Year 7 Residential as a full year group was a great success. The year group travelled to PGL Newby Wiske for 3 days of group team building and outdoor activities.

There were a wide range of activities that the students participated in including canoeing, archery, climbing, zip wires, a giant swing (which involved team work!) and bushcraft.

It was a significant undertaking for the school with large numbers of staff involved, not only with the students on the Residential, but also back at school. It was well worth it, and what made it even more pleasurable were some of the comments that we had from both students and Parents/Carers on return. Thank you to those individuals that took the time to make contact. Some examples of communications are below:

"XX had the best time and my ears are sore as she didn't stop talking about it last night."

"My son had a fabulous time and missed being in the hive last night with his friends! The big swing seemed to be a highlight 😊"

"He has come home and it's sooo lovely to see him full of confidence and happiness and hearing him speak so positively of the experience. Such lovely memories he will hold on to and I'm so grateful that he is part of such a loving and supportive school."

"I would like to express my gratitude and appreciation for all the opportunities that have been offered to me during residential. I had a great time thanks to you and the Crawshaw staff. I can understand how many hours you and the team have spent to give us a splendid time, thanks for all your efforts. Thank you for giving us many memories that will be cherished in our hearts."





One of our core Values is to support students being **Adventurous** and trying out new things. For example, there were examples of students who overcame nervousness when experiencing things that they had not done before. For some, this was the nature of activity whilst for others it was staying away for the first time. We are so proud of everyone who attended and fully immersing themselves in the visit.



HAYFEVER AND ANTIHISTAMINE

As the weather begins to warm up, we see the start of hay fever season and we inevitably have students requesting antihistamine medication from first aid. Unfortunately, this is not something we can routinely provide and ideally this should be taken in the morning before school. If a student does require antihistamine medication during the school day, then this should be handed in to main reception (with details of the dosage and times required). Also, for any of our students with asthma and any other breathing difficulties which require the use of an inhaler, then please ensure they always carry this with them.

SOCA

a) ON PARENT PAY

Due to recent requests, we now have a 'donate' button on ParentPay, that allows parents/carers to quickly and easily make donations to our PTA, SOCA if they wish.



b) DONATIONS

SOCA are holding a sweet and chocolate tombola stall at Pudsey carnival on Saturday 18th May. We would be very grateful for donations from parents of any of the following;

Chocolate bars/ boxes of chocolate/ bags of sweets/ any confectionery

If you can please send any donations into school with your child and they can drop them off either to Joss Appleby in SSC:L or to the student admin office.

Many thanks and, of course, please pop in to see SOCA on the day if you are attending the carnival.

SAFEGUARDING: NATIONAL CRIME AGENCY - SEXTORTION

Attached to the email with this Parent Briefing is a letter to Parents/ Carers from the National Crime Agency. It is rare that the NCA circulate such messaging and, therefore, I would urge you to read the information it provides, raising awareness of the recent rise



in reporting of financially motivated sexual extortion (a type of online blackmail often known in the media as 'sextortion'). The letter outlines what the crime is and how you as Parent/Carers can look out for the signs and take action to protect your child(ren) from this, in addition to the steps you should take should your child be a victim.

YEAR 11 – EXAMINATIONS AND REVISION

Next week sees the start of the Year 11 written examinations and the culmination of several years of hard work and months of revision and preparation. Thursday is the first written examination with Friday being the first full year group exam in the Sciences.

Parents can view all the examinations via your child's Arbor calendar. AM examinations begin with a Booster at 8.30 whilst PM examinations start with a Booster at 1.00 pm. A reminder that **PM examinations will**, in most cases, **extend beyond the usual school day** and plans should be made for this.

A reminder that the Student Portal, accessed via your child's Microsoft 365 login, has the Subject Hubs for a number of areas which include specific revision materials and guides. There is also a page devoted to revision techniques.

We have also **GCSE Pod** for all Year 11 students, a platform for GCSE revision. It is aimed to complement other revision strategies and is accessible through phones so can support revision on the go!

GCSEPOD has a proven effect on final grades. In a recent study on over 3,500 students it was found that on average **regular users of GCSEPod achieved 1 grade higher per subject than non-users.**

When used effectively, GCSEPod can have a **BIG** impact on final grades!



Data from over **3,500** students shows that higher GCSEPod users are **more likely** to exceed their predicted grades by a larger margin than those who don't use GCSEPod.

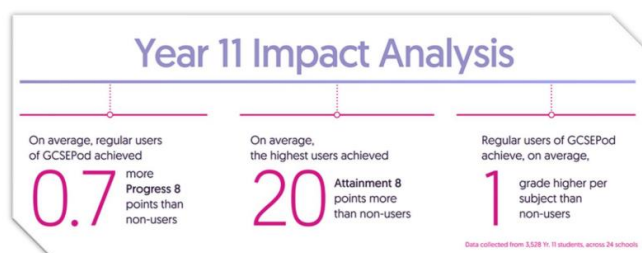

Students have unlimited streaming access to the GCSEPod website – that is access to over 6,000 Pods covering 27 subjects!



Pods are 3-5 minute long videos which pack all of the knowledge needed for their courses into short bursts.

Students can create digital flashcards and also create custom playlists of 'Pods'. A reminder that students just need to sign in to GCSEPod for the first time with their school Office 365 login. <https://members.gcsepod.com/login>

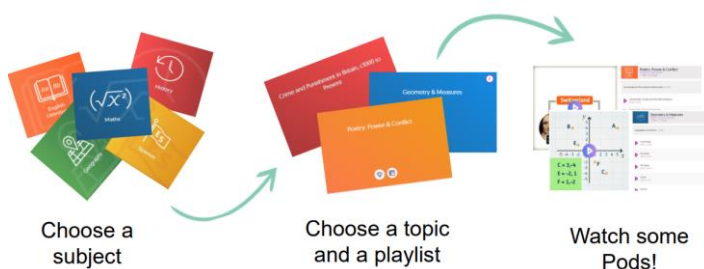

The Year 11 Leaver's Assembly is on Friday 21st June, Wednesday 26th June is the national examination Contingency Day (a reminder that Year 11 students must be available until this date) with the Year 11 Prom being on Friday 28th June. Year 11s have been wearing their Leaver's hoodies in school, visibly marking this important time in the school career!

We wish them every luck in the examinations.

ENRICHMENT AND EMPLOYABILITY:

Women in Manufacturing

On Thursday we held a fantastic 'Women in Manufacturing' Event. This was the biggest such event that the organisation has put on and involved over 160 girls from a range of different year groups. Students met with female employees from Manufacturing companies, from recently qualified apprentices, to highly skilled and experienced technicians and professionals, managing directors and company owners. They had the chance to meet, talk to and find out more about the careers of women working in manufacturing and engineering roles at all levels and at all stages of their careers. It was an opportunity to see beyond the stereotypes and begin breaking down barriers. The girls involved asked some great questions and it was an impactful event.

Aviation Academy

A group of Year 10 students took part in the Aviation Academy visit to Leeds Bradford Airport last week. The purpose of the visit was to understand more about the employment opportunities in the aviation industry. The trainer, Vicky, mentioned what a lovely group they were. All were excellently behaved, polite and showed a great interest. The group really got involved and asked some excellent relevant questions about careers within the airline industry.

ATTENDANCE

Attendance to school is arguably the single most important factor in a child's educational achievement. Year 11 results consistently show that where student's



attendance is high, they achieve well and show higher levels of progress than that of their peers whose attendance is lower.

So, while the relationship between attendance and performance is clear, the reasons may be less obvious.

Where students have higher levels of absence they might find:

- They have missed crucial knowledge or skills that have been taught
- The next part of the curriculum makes less sense, or they find it harder to learn
- They have less opportunity to practise what has been taught.

Alongside the demonstrable learning gains, attendance to school is also an important factor in the safeguarding and wellbeing of students.

Persistent absenteeism is defined as any student with attendance below 90% and as a result we would look to intervene with any student who is either below 90% or at risk of falling below 90%. This can be conversations in school, target setting, trackers, parental meetings or Local Authority involvement.

You can check and track your child's attendance on Arbor. For students that are absent for school, for example for multiple days in a row and perhaps with no good reason provided, this year we plan to increase the number of home visits we undertake. As part of these visits, we will look to support the child in returning to school. As always, we would ask Parents/Carers to let us know when their child will not be in school, and the reason why.

Finally, we do understand that children can struggle for different reasons at different times. If you do want to discuss any concerns you may have, or you have any further questions, please contact your child's pastoral team in the first instance and we will work together to ensure exceptional attendance and achievement.

REQUEST FROM STANNINGLEY ALBION JFC

Stanningley Albion Junior Football club have contacted us and asked if we could include the following message in our messages to Parents/Carers:

Stanningley Albion Junior Football Club are looking for new talent to join their current U12 girls and current U15 mixed football teams. The students interested in the girls team would need to be in current year 7 moving into year 8 in September and the mixed players would need to be in current year 10 moving into year 11 in September.

If you are interested in joining a friendly, inclusive and welcoming team please get in touch with Mark on 07884488865.



KITCHEN @ CRAWSHAW

Please see below for our menu for next week:

1		MONDAY	TUESDAY	WEDNESDAY	THURSDAY	FRIDAY
Main 1 £2.20	BANK HOLIDAY	BANGERS AND MASH Oven roasted sausages served with creamy mashed potato and steamed seasonal vegetables with lashings of gravy. (sd)	SPAGHETTI BOLOGNESE Chef Sandra's signature Bolognese sauce tossed through spaghetti and served with a slice of garlic bread. (gl)(sd)	MAC N CHEESE Macaroni pasta combined with a cheesy sauce, oven baked and finished with melted cheese and served with a fresh side salad. (mk)(gl)	POPCORN CHICKEN A Crawshaw favourite – breaded chicken chunks served with chips, sweetcorn and a helping of curry sauce. (mst)(gl)(h)(soy)	
Main 2 £2.20	BANK HOLIDAY	HAM & CHEESE PANINI A firm favourite with the students of Crawshaw – a soft panini filled with ham & cheese, served with oven baked seasoned wedges and a house salad. (gl)(mk)	CHICKEN TIKKA A traditional chicken tikka curry, chicken breast fillets marinated in tikka spices served with steamed rice and a naan bread. (h)(sd)(gl)(mk)	ITALIAN CHICKEN AND POTATOES Chicken breast strips marinated in Chefs spices, served with freshly made jacket potato wedges and salad. (h)(sd)	POPCORN CHICKEN WRAP Back by popular demand! Breaded popcorn chicken chunks wrapped in a soft flour tortilla with salad and mayonnaise. Served with chips and a helping of curry sauce. (mst)(gl)(h)(soy)	
Main 3 £2.20	BANK HOLIDAY	CHEESE AND TOMATO PANINI A soft panini filled with cheddar cheese and fresh tomatoes, topped with herbs and oven cooked. Served with our house potato wedges and a salad. (gl)(mk)(v) VEGAN OPTION AVAILABLE	VEGETABLE CURRY Chef's homemade vegetable curry made with seasonal vegetables and served with steamed rice and a naan bread. (sd)(gl)(ve)	MEATLESS ITALIAN NUGGETS Meatless nuggets marinated in Chef's spices served with freshly made jacket potato wedges and salad. (ve)(sd)	PARMIAGIANA Sliced Aubergine cooked in a rich tomato sauce with vegetables and topped with melted cheese, served with chips. (sd)(mk)(v) VEGAN OPTION AVAILABLE	
Available Daily		Sandwiches & pasta salads	Sandwiches & pasta salads	Sandwiches & pasta salads	Sandwiches & pasta salads	

A reminder that our catering website – www.cateringatcrawshaw.com - has everything to do with Catering at Crawshaw, including a **Pre Order Portal for students to use** to jump the queue. You can preorder:

- Cold Sandwiches, Baguettes or salads, to include our meal deal offer of a drink and homebaked treat **for £2.60**
- The option for a premium preorder which includes a wrap, pasta or salad with 2 toppings and 2 sides for **£3.00**.

Once ordered their lunch can be collected from a designated collection point in the canteen, thereby jumping the queues.

Kind regards

Robin Ghosal
Associate Principal

Crawshaw Academy, Robin Lane, Pudsey, Leeds LS28 9HU
Tel: 0113 5323810 | Email: info@ca.rklt.co.uk | www.crawshawacademy.org.uk
Principal: Mr A Daly

Crawshaw Academy is part of Red Kite Learning Trust, a charitable company limited by guarantee registered in England and Wales with company number 7523507. Registered office address: Arthurs Avenue, Harrogate HG2 0DZ.

